

SHAW'S PLAZA RAYNHAM

300 New State Highway | Raynham, MA 02767

SPACE	TENANT	SQ. FT.
ATM	AVAILABLE	504 SF
OPI	Popeyes	1,986 SF
SHADI	Bernie and Phyl's	
01	Answer is the Fitness Gym	4,767 SF
02	GNC	1,760 SF
03	T-Mobile	3,000 SF
04	One Foot Spa	2,400 SF
05	Star Nail and Spa	2,400 SF
06	Supercuts	1,600 SF
08	PetSmart	14,000 SF
09	My Village Playhouse	5,560 SF
09A	Dental Dreams	3,840 SF
10	Bank of America	3,500 SF
11	JOANN	15,775 SF
12	Santander Bank	2,274 SF
13	Panera Bread	4,000 SF
14	Shaw's Supermarket	60,748 SF
15	Marshalls	25,752 SF
16	Dragon Nails	3,200 SF
17	Five Below	9,100 SF
18	GameStop	1,537 SF
19	CVS	10,125 SF
TOTAL SQ. FT.		177,828

SITE LEGEND

- Available
- Occupied
- Leased (not occupied)
- Owned by Others
- Site Boundary

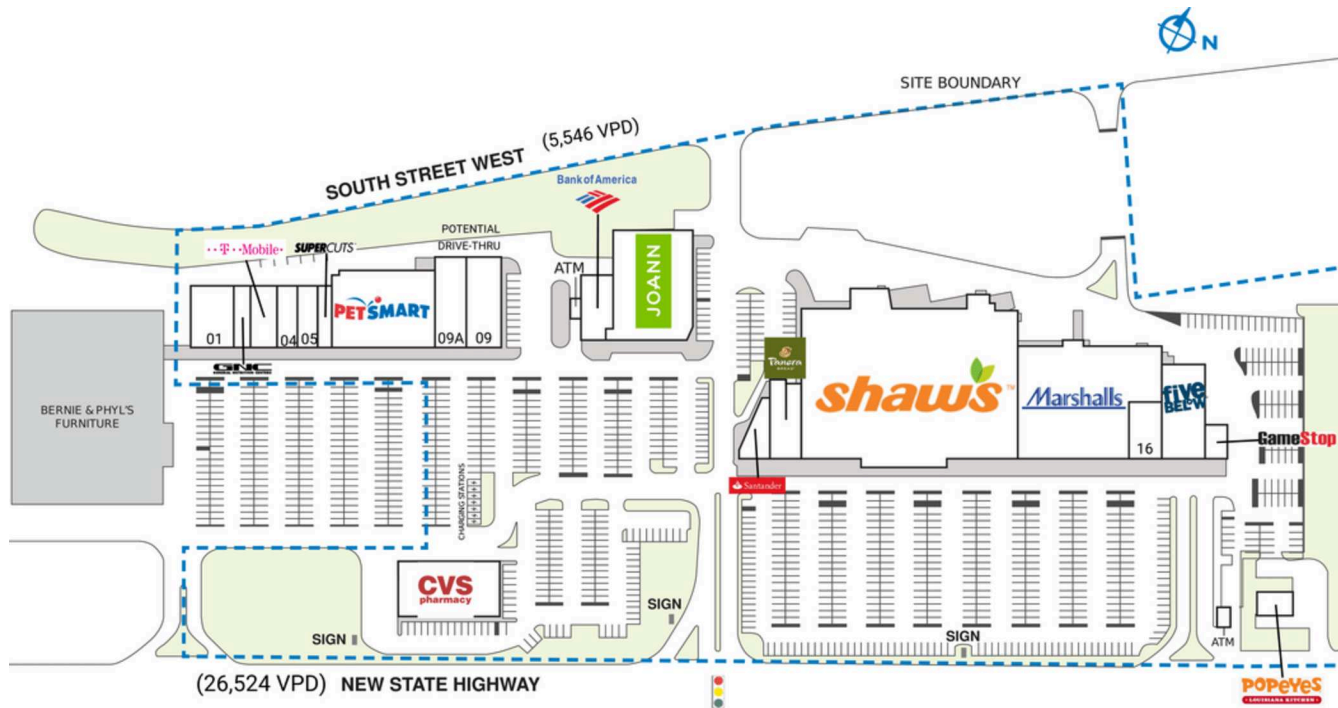

DISCLAIMER - This site plan is for general information purposes only and is not intended to constitute representations and warranties by Landlord as to the ownership of the real property depicted herein or the identity or nature of any occupants thereof.